

200mm PRESTRESSED CONCRETE SLAB 29.512-00 - SAFE LOAD TABLE 14/01/2024

Self Weight 297Kg/m - SAFE LOADS are exclusive of self weight (60mins fire resistance)

EFFECTIVE SPAN (see fig A for explanation)		PRELIMINARY UNIFORM SAFE LOAD (0 infilled holes)	SHEAR 0 INFILLED HOLES	BEARING 0 INFILLED HOLES	PRELIMINARY UNIFORM SAFE LOAD (2 infilled holes)	SHEAR 2 INFILLED HOLES	BEARING 2 INFILLED HOLES	9mm TOP WIRES
meters	feet	Kg/m ²	T/panel	mm	Kg/m ²	T/panel	mm	
3.0	9'10"	2,989	5.38	100	4,333	7.80	100	-
3.5	11'6"	2,519	5.29	100	3,672	7.71	100	-
4.0	13'1"	2,167	5.20	100	3,175	7.62	100	-
4.5	14'9"	1,896	5.12	100	2,793	7.54	100	-
5.0	16'5"	1,677	5.03	100	2,407	7.45	100	-
5.5	18'0"	1,497	4.94	100	1,945	7.36	100	-
6.0	19'8"	1,347	4.85	100	1,593	7.27	100	-
6.5	21'4"	1,223	4.77	100	1,319	7.19	100	-
7.0	23'0"	1,102	4.68	100	1,102	7.10	100	-
7.5	24'7"	927	4.59	100	927	7.01	100	-
8.0	26'3"	783	4.50	100	783	6.92	100	-
8.5	27'11"	665	4.42	100	665	6.84	100	-

Notes to Periti: Refer also to guidelines: <http://www.gmfprecast.sandbox.local.com.mt/technical-specs>

- (A) Load tables conforming to *MSA EN 1992-1-1 Eurocode 2: Design of concrete structures - Part 1-1: General rules and rules for buildings*, with both the safe load values satisfying the serviceability limit state (SLS)
- (B) For HC slabs resting on beams, filling of hollows in C30 concrete at supports is recommended.
- (C) The minimum bearing of HC slabs as per table above is to be a minimum of 100mm depending on the loads & strength C30 of padstone suletta, important to have a fair-faced finish to the top surface.
- (D) For all load patterns, eg point loads, these are to be converted to equivalent uniform loads, whilst the **actual** shear load needs to be addressed.
- (E) The selection of *plank* type is the responsibility of the client's *Perit*.
- (F) Embodied carbon is measured per square meter on plan.

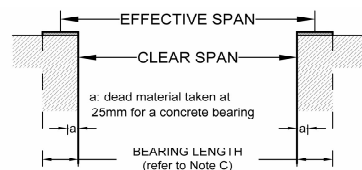

Fig. A

200

Concrete Grade: C45
 Area: 0.121m²
 Hole Area: 0.112m²
 Weight / m: 297kg/m
 B_w: 241mm
 I_{xx}: 62,366cm⁴
 Y_c: 101mm
 Y_b: 99mm
 Embodied Carbon: 57kgCO₂e/m²

